



Total Food-Service Solutions

## Modular Cooking – Meritus 750

### Electric Griddle Pan

#### NEGP 4-75 MR



\*Due to routine technical improvement, the photograph shown may not represent the latest design of the products.

#### AVAILABLE MODEL

1. NEGP 4-75 MR

#### DESCRIPTION

Electric Griddle Pan with 4.6 kW power rate. Water temperature maintained by thermostat with maximum working temperature of 300°C. Unit to be installed on open cabinet or similar elements, cantilever, or solid block solutions. Featuring removable clip joint to connect Meritus family product.

ITEM# : \_\_\_\_\_

MODEL# : \_\_\_\_\_

NAME : \_\_\_\_\_

SN : \_\_\_\_\_

#### MAIN FEATURE

- Maximum working temperature of 300°C.
- Unit to be installed free standing, can be joined with base cabinet, table stand or cantilever system.
- Service maintenance can be done from the front panel.

#### CONSTRUCTION

- All exterior panels in 304 type of Stainless Steel.
- Orbitel top panel anti-scratch finishing.
- Top and side are mounted by 1.5mm of Stainless Steel.
- Adjustable  $\pm 25$  mm Stainless Steel leg.
- Material Griddle is SS420 (t = 20mm).

#### INCLUDED ACCESSORIES

- Food Pan GN 1/1 x 100
- Nylon Drain Plug

#### OPTIONAL ACCESSORIES

- Clip Plate for Joining

: \_\_\_\_\_

The company reserves the right to make modifications to the products without prior notice. All information correct at time of printing.  
2018.06.25



**FRONT**

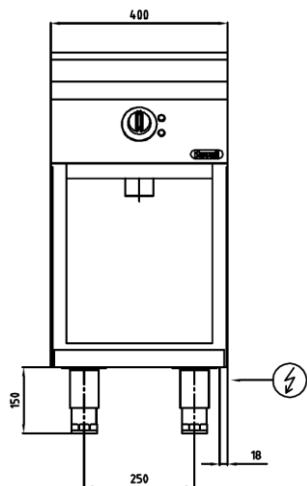

**TOP**

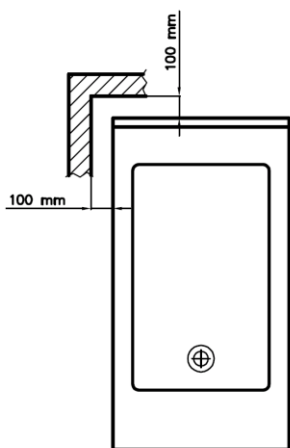

**SIDE**

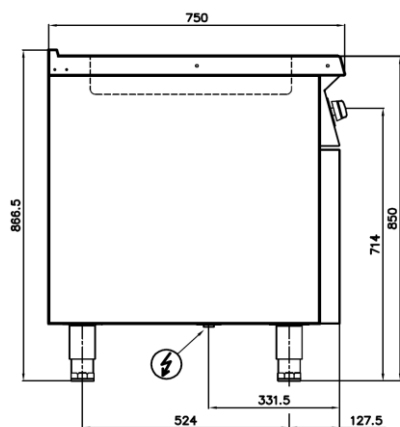

Electric Connection

\* Overall Dimension in mm

**ELECTRIC**

Electrical rating (kW)	:	4.6
Element rating (kW)	:	4.6
Electrical supply voltage	:	400V 3N
Required electrical supply (amps):		16
Electrical current split (amps) :		L1 : 15.45
		L2 : 15.45
		L3 : 5.54

**KEY INFORMATION**

Cooking surface (WxD)	:	310 x 510 mm
Direct heat emission	:	1.15 kW
Latent heat emission	:	1.84 kW
Steam emission	:	2.70 kg / h
Min. working temperature	:	50°C
Max. working temperature	:	300°C
Capacity	:	15 L
Shipping height	:	1000 mm
Shipping width	:	460 mm
Shipping depth	:	840 mm
Shipping volume	:	0.386 m <sup>3</sup>

\_\_\_\_\_ :

The company reserves the right to make modifications to the products without prior notice. All information correct at time of printing. 2018.06.25